



# GCDD COUNCIL MEETING



October 18-19, 2012

Unicoi State Park - Helen, GA



## People Present At Council Meeting

- Council members
- Advisory
- Staff
- Guests

♂ Carl Flair

♂ Tom Connolly

♀ Christine Fleming

♂ Tameeka Hunter

♀ Julie Lee

♂ Denny Spear

♂ Scott Crain

♂ Kim Chester  
♂ Zo Stoneman

♂ Katie Chandler

♂ Ron Pound

♀ Dorothy Harris

♀ Cheri Pace

♀ Kylie Moore

♀ Colleen Pirkle

♀ Teresa Johnson

♀ Lisa Newburn

♀ Teresa Brenner

♂ Eric Jacobson

♀ Pat Nobbie

♀ Dottie Adams

♀ Caitlin Childs

♂ Eric Foss

♀ Dee Spearman

♀ Valerie Suber

♂ Gary Childers

♀ Sharon Strandberg

♀ Kim Person

John O'Brien

Lisa Brewer

Erin Moore

Heather Anderson

Aarti Sahgal

Leslie Hale

Varion Spear

Jay Suber

Radio Shows done today



O'Neill Approved by Committee

New Edition is on the Table

Next Council Meeting

Jan 17-18 at 2 Peachtree (2nd floor)

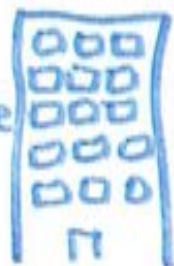

GCDD Honored on Nov 1st by NAACP



Pat Nobbie - BIG VOICE FOR CHILDREN AWARD for legislative efforts

CONGRATULATIONS!



Governor Appointments Working on it ??? Maybe

Volunteers for INNOVATIVE Grant Committee

- 1. Tom C. 2. Ron P. 3. Julie L. 4. Teresa B.

STAFF CHANGES

Dottie retired - back 1/2 time
Anne left
Pat leaving for Kennedy Fellowship - DC
Drelda left - Sharon helping now

itart announcement 1 Policy 2 Grassroots Advocacy 3 Organizing Coordinator 4 Grant 5

THINGS ATTENDED

Tom C.

Oct - Employment Month Proclamation

Dorothy

People 1st Conference  
Conversations that Matter (valdosta)  
Transition/Post secondary

Oct 25th - Gainesville Conversation that Matters Colleen  
Bright Futures - Project Search



ARC Plane Pull  
Sat Oct 20th

Julie  
Pat

Katie  
DOJ has recommended SRV training  
GAO - does that  
NPR - radio story on CFI by Katie

Kylie

GSU - Life Skills

Colleen

Project Search Conference  
Hall Co got 100% Award Youth Leadership

Leslie  
UGA  
Post Secondary Meeting

Pat

Conversation that Matters Kennesaw

2 Senators there  
Meetings with Legislators - Heads Up

LEND - GSU - CFI was selected as a project  
Meet with Commissioners on 14th  
CFI meets Nov 19th

Teresa J

Nov 10th - Walton Navigator Team  
Family Fun Day - Resource Fair  
December - Jingle Jog 5K

Kim C.

Poverty Simulation  
what it takes to get through  
day/week

Scott

Task - Make it work  
Feelings of Defeat/Frustration  
Realistic - Emotional

Teresa J

↑ sensitivity  
Impactful - Life changing  
Points out system issues  
changed how I do my work

Family Connection can request this at No Cost

Shows Importance of  
FAMILY SUPPORT

- Back Pack Buddies
- Initiatives - How to Help
- ↑ Awareness → ACTION
- ... How  comes together  
community
- ... How do you get policymakers  
to go through it?

Attitude shift Needed

But it must lead to ACTION, too

# GEORGIA WINTER INSTITUTE (GWI)

January 6-9, 2013  
Columbus, GA

- \* John McKnight
- \* John O'Brien
- \* Bruce Anderson
- \* Connie Lyle O'Brien
- \* DeAmon Harges

Ⓢ Dottie is going to be a Grandma again in June!

NACDD - October Conference  
Cancelled

ERIC JACOBSON

20 YEAR  
ANNIVERSARY  
AT GCDD

2013 COUNCIL  
MEETING DATES

Jan 17-18 - Atl  
Apr 18-19 - TBA  
July 18-19 - Atl  
Oct 17-18 - TBA

CONSENT AGENDA

- sent out in advance
- don't have a quorum
- will approve later by email vote

# REVISED BUDGET

Approved budget in July

Adjusted budget

Personnel Line

↓ \$5000 - \$10,000

? Pat's Leaving Date

Staff start dates

↑ 1/2 x employee

Regular Operating Expenses

↓ \$9000 - \$10,000

Dues

↓ \$5000



Move \$ Savings to Programmatic Budget

Help with the loss of the Family Support Grant & Real ITM Communities

2.1 Million - Federal \$ - Oct 1st

Guestimate

Economy - Jan 1st

Election ?

Fiscal Cliff (8.5% cut to AIDD & others)

500 Billion to be cut from Domestic & Military if not resolved

## BUDGET IS COMPLICATED

- Have 3 YEARS TO USE IT
- 2 YEARS TO OBLIGATE \$
- 3rd YEAR TO LIQUIDATE

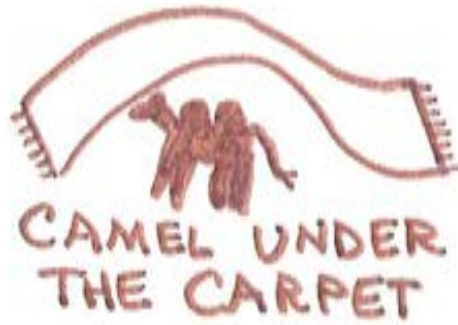

2 Large Contracts  
Projects hadn't been encumbered  
(Partnerships for Success)  
Making A Difference  
Looks like we only spent 70% of Budget

Will send out revised fiscal report  
budget - Relook at figures

Carryover is about \$550,000

Can't vote on it - don't have a quorum

## REAL COMMUNITIES

#1 Julie Eric  
Denny Gary  
Ron Aarti  
Carl

#3 Scott Pat  
Dorothy Zo  
Teresa x 2  
Cheri  
Leslie

#2 Christine Kim  
Kylie Caitlin  
Colleen Sharon  
Lisa

#4 Tom Dottie  
Katie Lisa B  
Tameeka Dee  
Valerie



GROWTH  
FOR  
REAL JM

GUIDANCE  
FOR  
GROWTH



HEART



OF  
REAL JM

WHAT TO KEEP &  
BUILD ON

- \* relationships
- \* break down walls
- \* JM decides what is important
- \* Everybody's time is equal
- \* Understanding the process/resources
- \* What is already in the JM
- \* Invitation
- \* Learning Journeys valuable - don't know what you don't know
- \* Encouraging intentional conversations
- \* SUSTAINABILITY - Keep it going & inclusive to all
- \* Relationships - process & outcome important
- \* Who we are as a COUNCIL
- \* Outcomes for JM
- \* Bring ♀♂ together - synergy - travel together
- \* Community Builders - as the HUB - hold the integrity & knowledge learned



- \* Flexibility
- \* Not a Program
- \* Creativity

## WHAT DO WE WANT TO LEARN

- Who is missing at the table & why
- How to make these good things happen over time as we fade out
- Common Key elements toward success
- How to reach ♀♀ on the margins
- How community builders foster conversations, buy in, and community engagement
- What trainings are helpful
- How does the power base work in communities - formal / informal
- Does Real IT result in improved lives for ♀♀ with disabilities
- Does Real IT impact ↑ ↓ in need for formal services
- How to not limit creativity by not pushing a "best practice" model
- How is ABCD used as a tool for IT change
- What has failed/succeeded... want to push the envelope.

- What are factors that interfere
- What criteria do we use in expanding to new communities

## GUIDE GROWTH

- \* 4 Areas
  - Expand? How? - close by or New
  - Add additional ITM? - strategic location
  - Growth / internal resources Build on something happening - tag on
  - Growth / Nationally Ratio 2:1 - with other DD Councils

\* Do a few things WELL  
 Not just going for #'s that might be mediocre

- \* How to find new ITM's
  - Looked for fertile ground previously
  - Communities that approach us
  - Be in Communities - recognize possibilities

\* Want to look for "Not the usual suspects" ... outside disability - new allies

- \* Beginnings ... happening with foundation already there
- \* Build on strengths - relationships - connections

## LOGIC MODEL for Real

Will be sent out as a separate document

**FRIDAY**

MIA'S BIRTHDAY



AD HOC PUBLIC POLICY COMMITTEE

1. Tameeka H.
2. Lisa N.
3. Scott C.

PROPOSED LEGISLATIVE AGENDA 2013

(5 YEAR PLAN)

- \* UNLOCK
- \* IDA
- \* EMPLOYMENT 1st
- \* HOME ACCESS
- \* DIPLOMA OPTIONS
- \* MEDICAID MANAGED CARE
- \* OTHER (WHAT COMES UP)

# Governor's Instructions

3% cut

DBHDD - can't cut Federal \$  
4% cut from state \$

Cut from rest of FY 2013  
\$27,818,095

[from UPL one time "win fall"]

## FY 2014 Budget

wants unlock to help educate  
legislators that 9.4 million -  
is a cut in SERVICES

Have to see what is in the  
Governor's Budget

## PROPOSED

ADA (DOJ settlement) \$19,206,334

### FIGHT FOR IT

- Crisis respite 3.8 million
- 250 waivers 6.0 million
- Annualized waivers 7.4 million
- Family Support 1.8 million  
(500 new families)

19.2 million

MH - Medicaid  
Rehab Option - \$2,500,000

# INDEPENDENT REVIEWER - Elizabeth Jones

## 2 Areas of Non-Compliance

1. Getting services in ISP  
(48 ♀ - not getting what they need)
2. Monitoring ISP to make referral:  
Service changes, plan amendments as needed  
(Had support coordinators but services lacking)

### DOJ Settlement

FY 2011

192 transitions  
146 in Group Homes  
43 in Host Homes  
3 in own/family

FY 2012

168 transitions  
160 in group homes  
4 in host home  
4 own/family

Last 2 Years

85% transitioned to  
13% to Group Homes  
to Host Homes  
2% to own/family

# DCH BUDGET

400 million deficit - 2013

501 million deficit - 2014

## HOME / COMMUNITY BASED SERVICES (HCBS)

COMMUNITY CARE (CCSP)	10,052 on	1069 waiting
SOURCE	19,017 on	357 waiting
Independent Care (ICWP)	1187 on	101 waiting
New Options Waiver (NOW)	5071 on	2735 waiting (short term)
COMPREHENSIVE WAIVER (COMP)	6365 on	4038 waiting (long term)

## WAIVER CONCERNS

4 waivers

Different terminology

Different rates

DOJ impact on DD waivers

deinstitutionalization focus

Not waiting list focus

# BALANCING INCENTIVES (BIP)

➔ Move ♀ to  COMMUNITY

extra 3%      19 Million Extra

— Requirements —

- Reinvest in HCBS
- Conflict free Support Coordination
- Single Point of Entry (ADRC)

Hard to Track \$  
No stakeholder Group

## MONEY FOLLOWS THE PERSON (MFP)

954 total as of 9/30/12

90% Federal \$ / 10% state \$  
for 1st year

## OLMSTEAD

Delayed the vote

Unlock sent letter to Commissioners  
Stacey R - doing crosswalk - current / 2010 15

# INDIVIDUAL DEVELOPMENT ACCOUNTS (IDA)

Going to go for it again  
3rd try - Governor vetoed last year  
Have to get it on Governor's  
Agenda

## EMPLOYMENT FIRST

↑ Rate for Supported  
Employment

DIPLOMA Capstone Project  
4 Pathways (electives) 4 Eng, 4 Math, 4 Science  
3 Social Studies  
High School Diploma 1 Health/PE 7 electives

- IEP - completed integrated curriculum
- Proficient GAA scores in all areas
- Reached 22nd Birthday or transitioned to employment

High School Certificate  
Special Education Diploma



## MANAGED CARE

Kids in Peachcare  
are in Managed  
Care Now

ABD (Aged, Blind, & Disabled)

Want to bring into Managed Care  
Have bowed out for Now

Spent 3 Million for a Report  
that was worthless

Very Complicated!

Coalition formed

AZ only state  
doing it  
they started  
out that  
way

Foster Kids - transient

1 CMO

- \* Improve coordination
- \* electronic medical records
- \* Medical home

## UN CONVENTION

Rights of ♀♀ with Disabilities

Want it ratified - want it passed  
during lame duck session

Johnny Isakson supported

Want letters to go to Senator Chambliss (17)

# MEETING EVALUATION / COMMENTS

 Tameeka

Liked Real   
Conversations

 Tom C.

Liked seeing everyone  
Appreciated updates

 Dee

Good seeing everyone

 Kim

Pat will be missed  
Acknowledge her

 Katie

Pat's Legislative Agenda  
Update

Logic Model

John O'Brien's facilitation/summary

 Zo

Was a joy being here  
Contrast w/ pessimistic climate  
barriers / challenges we face

 Dorothy

Educational!

Welcome New advisory members

 Lisa

Learn a lot quickly

 Teresa

Enlightening

Proud to be part of it

Kim C. Lots of info  
Will miss Pat

Sharon Council Meeting is like  
a staff meeting on steroids!

Eric F Nice Meeting  
Going to miss Pat

Scott Will miss Pat ... he is losing 3 strong  
support people  
Meetings always good  
Council work is important  
Good stewards of \$

Pat Patti Solomon Roast @ DOE  
Oct 29th 11-1

Cheri Thanks for Pat's Voice  
Liked the loft in her room  
Impressed  
Good Participation  
John O'Brien - facilitation  
Logic Model  
Fantastic

Julie Networking  
Made my sister feel welcome

Kylie - 1st one - Good Luck, Pat.

 Denny

Good thing  
Friendships  
Meeting - production  
Sound system is a problem  
Demanding time - thanks for  
putting up with it



New Ideas Birthed  
New Relationships 

 Christine

Hard work - Council Staff  
Welcome New   
Great week



 Teresa

Pleasure  
Meet New   
Lots to learn  
Chance to sink in  
Appreciate friendliness  
of the group

 Colleen

Thankful to be part of this  
Opened my eyes to what  
we should be doing

 Leslie

Hope in   
Budget Issues Galvanize  
Good things that can happen  
Carry it with us to make an impact 

C Caitlin

Real JTH  
John's facilitation  
Summarize  
Good to see everyone  
meet new advisory  
members  
No one can fill Pat's shoes

D Dottie

Safe environment to ask  
questions ... get clarity  
Big deal - Kennedy Fellowship!  
500 applications  
5 interviewed  
Pat is the ONE chosen